

INSTRUCTIONS

5950 Triangle Frame Bag

NOTE: Dirt and dust from riding on road or trails may get under straps and cause abrasion and/or damage to frame. **Periodically inspect and clean the surface.** You may wish to use a protective layer between strap and frame.

Spot clean or hand wash with cold water and mild detergent. Drip dry only. Use only non-chlorine bleach when needed.

NOTE: Be sure to **completely zipper compartment closed** while riding so as to not lose contents of bag. Periodically **check straps** to ensure they are tight and secure.

usa.zefal.com

PRODUCT INFORMATION | INSTRUCTIONS | CUSTOMER SERVICE

For customer assistance call
800-278-2565

1

Position bag as shown or in desired location

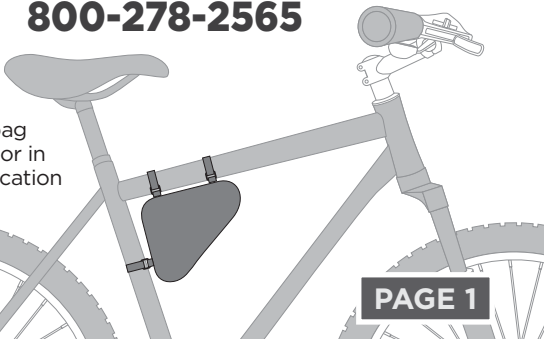

PAGE 1

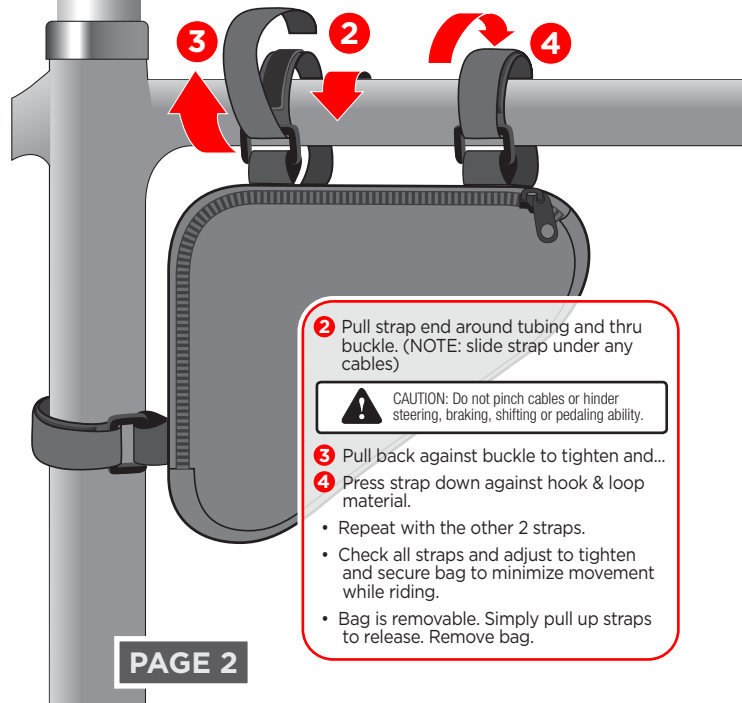

2 Pull strap end around tubing and thru buckle. (NOTE: slide strap under any cables)



CAUTION: Do not pinch cables or hinder steering, braking, shifting or pedaling ability.

3 Pull back against buckle to tighten and...

4 Press strap down against hook & loop material.

- Repeat with the other 2 straps.
- Check all straps and adjust to tighten and secure bag to minimize movement while riding.
- Bag is removable. Simply pull up straps to release. Remove bag.

PAGE 2